

THIS INFORMATION IS CONFIDENTIAL AND IS DISCLOSED TO YOU ON CONDITION THAT NO FURTHER DISCLOSURE IS MADE BY YOU TO OTHER THAN TETULL PERSONNEL WITHOUT WRITTEN AUTHORIZATION FROM TETULL LTD.

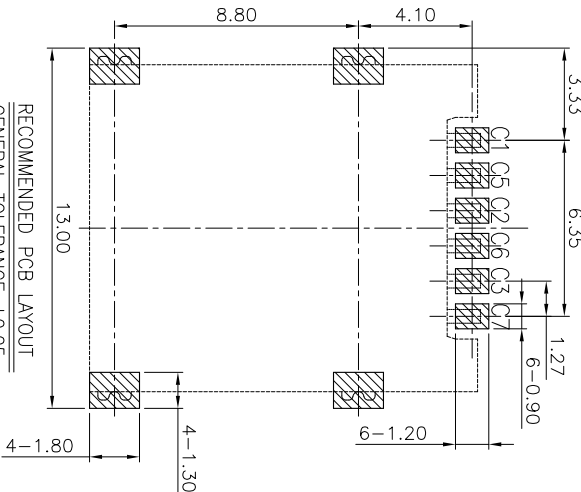

NOTE:

1. ELECTRICAL CHARACTERISTICS
 - 1-1. VOLTAGE RATING: 12V DC.
 - 1-2. CURRENT RATING: 1.0 A.
 - 1-3. CONTACT RESISTANCE: 60 milliohms MAX.
 - 1-4. INSULATION RESISTANCE: 1000 Megohms MIN.
 - 1-5. DIELECTRIC WITHSTANDING VOLTAGE: 500V AC FOR 1 MINUTE.
2. MECHANICAL CHARACTERISTICS
 - 2-1. RETENTION FORCE: 100gf MIN./PIN.
 - 2-2. DURABILITY: 5000 CYCLES.
 - 2-3. SALT SPRAY: 24H.
 - 2-4. OPERATING TEMPERATURE: -40°C~85°C.
 - 2-5. RoHS 2002/95/EC COMPLIANT.
 - 2-6. MPQ : 1500PCS/REEL.

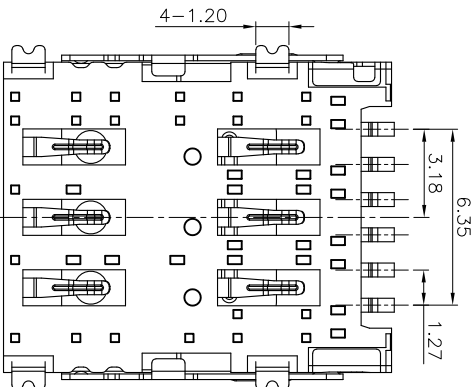
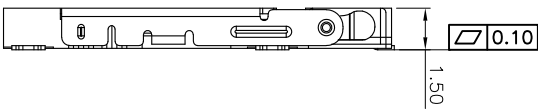
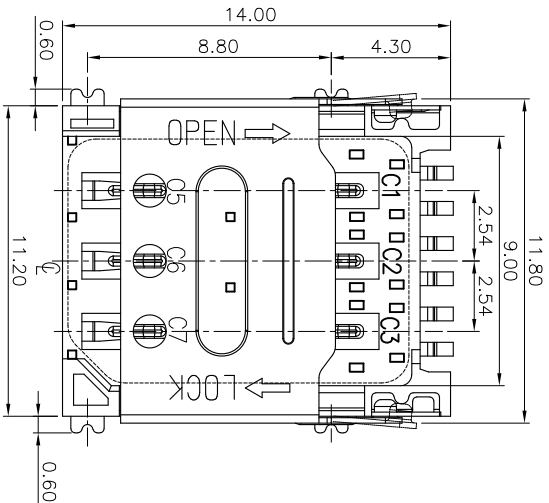
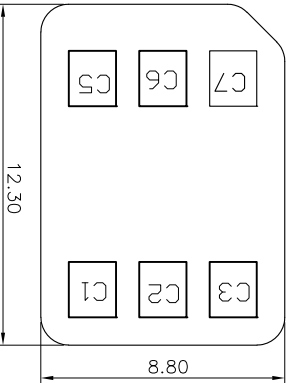

SIM pin Assignment	PIN#	Name
C1	C1	VCC
C2	C2	RST
C3	C3	CLK
C5	C5	GND
C6	C6	VPP
C7	C7	I/O

NANO SIM CARD

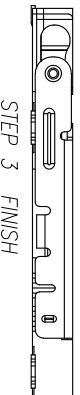
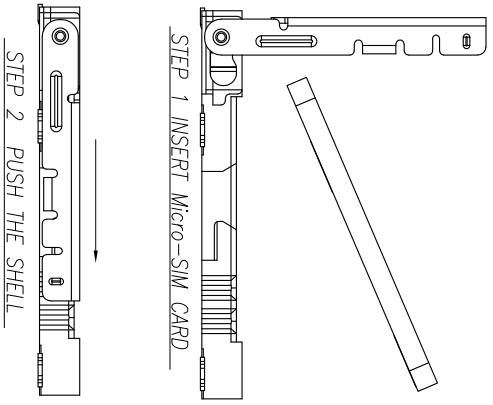

NO	DESCRIPTION	QTY	MATERIAL	PLATING & COLOR
C	SHELL	1	STAINLESS STEEL 0.15t	Ni PLATING
B	CONTACT	6	COPPER ALLOY 0.15t	Gold plated on contact area Gold plated on Solder tail All over Nickel plated
A	HOUSING	1	HIGH-TEMPERATURE PLASTIC U94-10	BLACK

DECIMALS:	ANGLES:
X : ±0.5	X : ±2°
X.X : ±0.3	X.X : ±1°
X.XX : ±0.2	



TITLE:	NANO SIM CARD 6P 1.5H
PART NO.	1050626AR101
DWG	BROKEN
CHKD	2015.05.18
APVD	
SCALE 1:1	
SIZE: A4	
SHEET: 10F1	
REV: A	