

THIS INFORMATION IS CONFIDENTIAL AND IS DISCLOSED TO YOU ON CONDITION THAT NO FURTHER DISCLOSURE IS MADE BY YOU TO OTHER THAN TETULL PERSONNEL WITHOUT WRITTEN AUTHORIZATION FROM TETULL LTD.

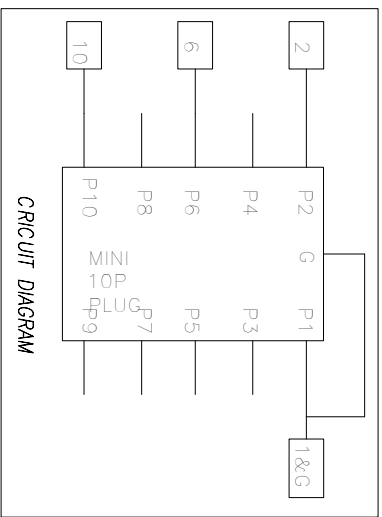
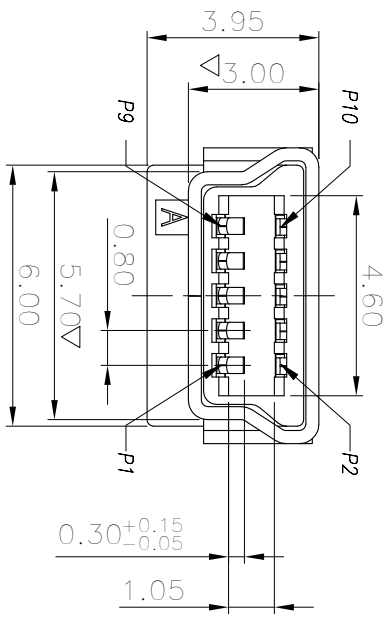
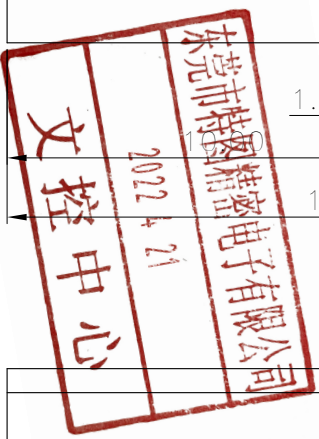
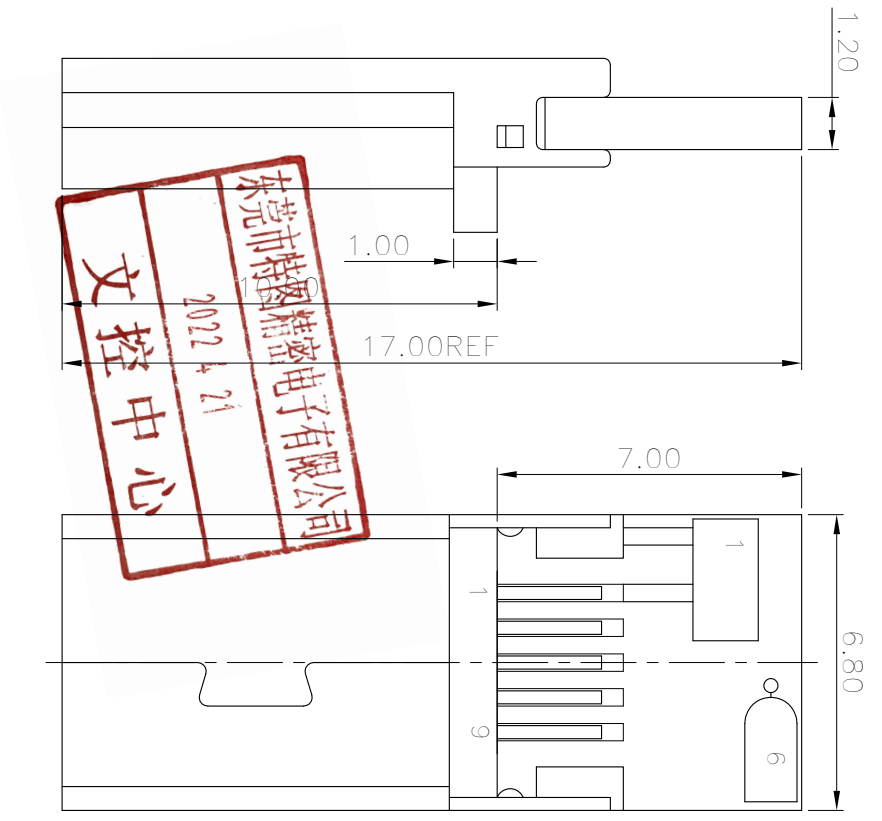
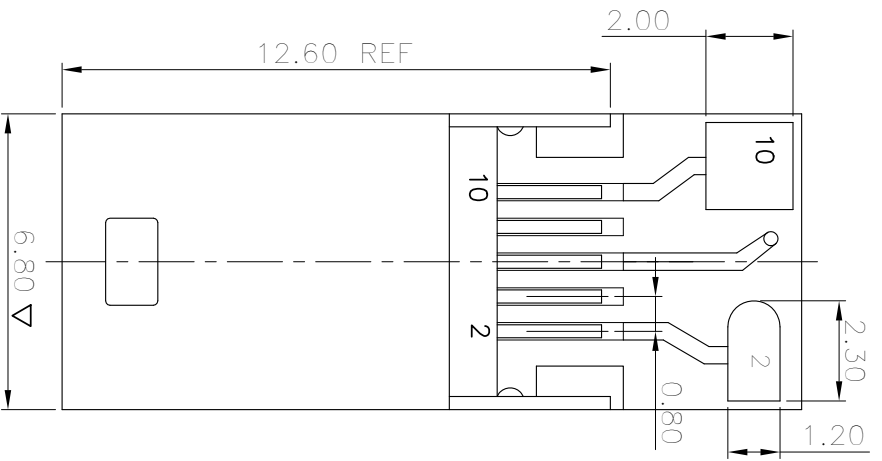

NOTE:

- ELECTRICAL CHARACTERISTICS
 - 1-1. VOLTAGE RATING: 30V AC
 - 1-2. CURRENT RATING: 2.0A
 - 1-3. CONTACT RESISTANCE: 50 milliohms MAX.
 - 1-4. INSULATION RESISTANCE: 100 Megohms MIN.
 - 1-5. DIELECTRIC WITHSTANDING VOLTAGE: 500V AC FOR 1 MINUTE.
- MECHANICAL CHARACTERISTICS
 - 2-1. MATING&UNMATING FORCE: 0.7kgf~3.5kgf
 - 2-2. DURIBILITY: 10000CYCLES
 - 3. SALT SPRAY: 24H
 - 4. OPERATING TEMPERATURE: -40C~85C
 - 5. ROHS 2002/95/EC COMPLIANT.
 - 6. CRITICAL DIMENSIONS : ▽

REV/ECN	NO OR DESCRIPTION	REVISED	DATE
A	PRODUCT RELEASE	MKE	2012.09.25

NO	DESCRIPTION	QTY	MATERIAL	PLATING & COLOR
D	PCB	1	FR4-1	表面綠漆
C	SHELL	1	BRASS 0.30t	Ni PLATING
B	CONTACT	10	CS191 0.20t	Gold Flash On Contact Area Tin plated on Solder tail All over Nickel Plated.
A	HOUSING	1	LCP	BLACK

UNLESS OTHERWISE SPECIFIED TOLERANCES

DECIMALS: ANGLES:

X.XX : ±0.2 X.X : ±0.3 X.XX : ±1°

TETULL

MINI 10P公头線PCB插孔=17.0 (4点1-6、2、6、10)

PART NO. 1031002GR019

DWG. MIKE 2012.09.25

CHKD

APVD

SCALE 1:1 UNIT: mm

CUSTOMER COPY SIZE: A4 SHEET: 10F1 REV: A

